

# 70-1905-72 DOOR WEATHERSTRIP KIT

FITS DOORS FOR ALL 1969 Chevrolet "B" Body 2 DOOR SEDANS

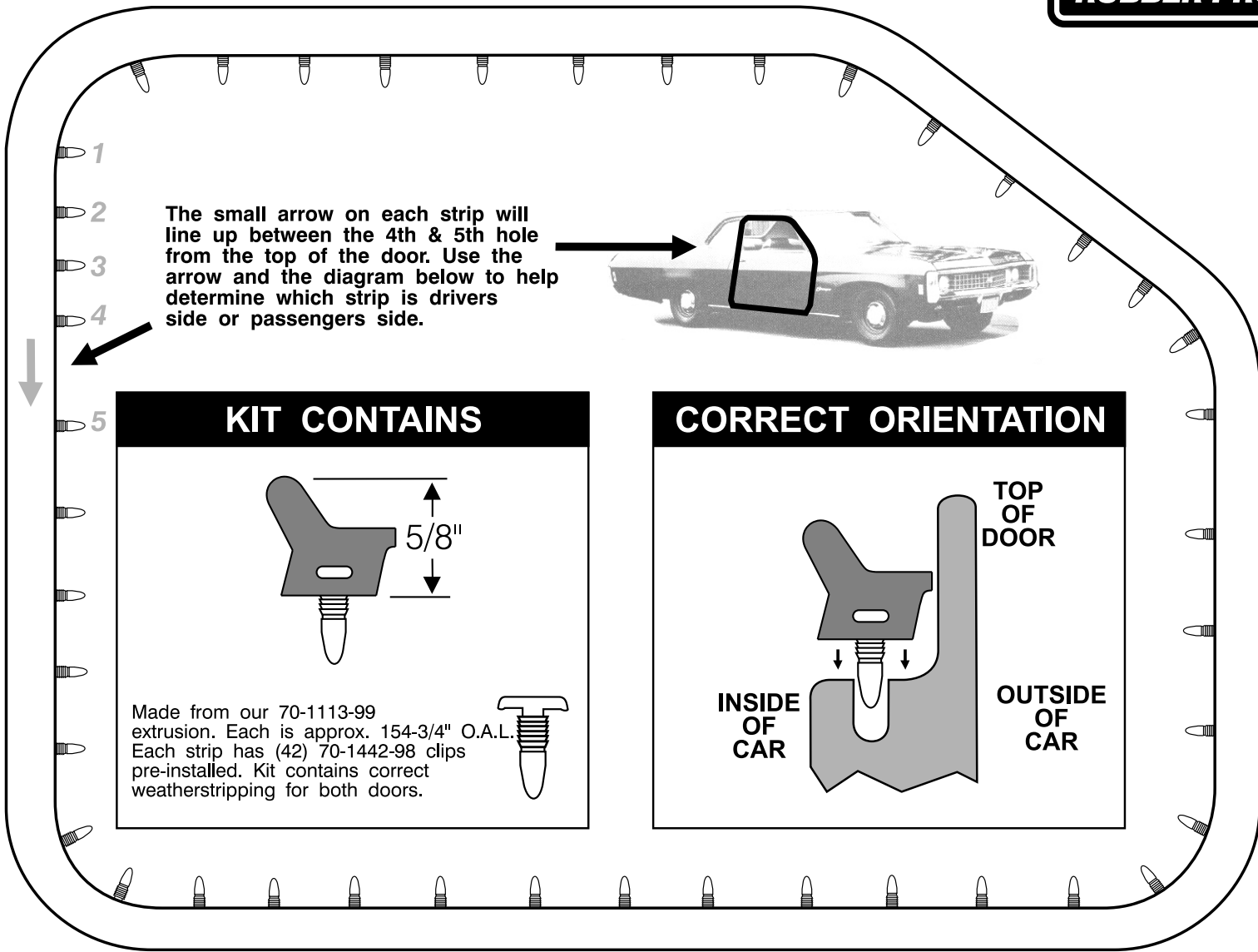

The small arrow on each strip will line up between the 4th & 5th hole from the top of the door. Use the arrow and the diagram below to help determine which strip is drivers side or passengers side.

### KIT CONTAINS

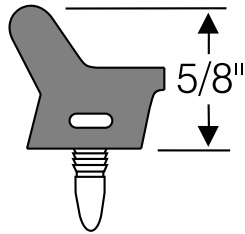

Made from our 70-1113-99 extrusion. Each is approx. 154-3/4" O.A.L. Each strip has (42) 70-1442-98 clips pre-installed. Kit contains correct weatherstripping for both doors.

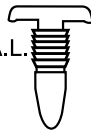

### CORRECT ORIENTATION

